

This document is the property of Amphenol Corporation and is delivered on the express condition that it is not to be disclosed, reproduced or used, in whole or in part, for manufacture or sale by anyone other than Amphenol Corporation without its prior consent, & that no right is granted to disclose or to use any information in this document.

Customer drawing

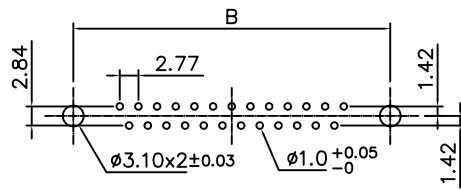

RECOMMENDED P.C.B LAYOUT
(TOLERANCE +/-0.05)

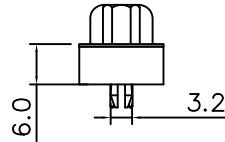
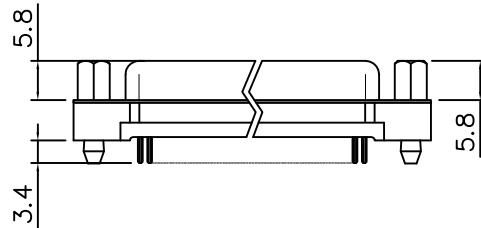
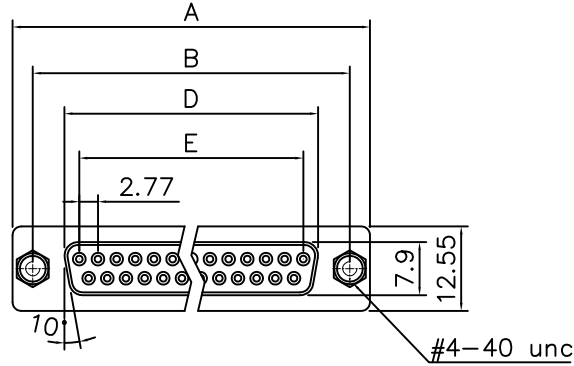
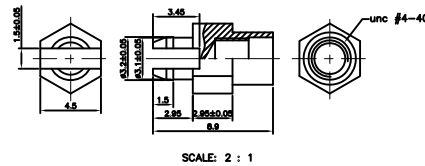

Dimensions

Shell Size	Positions	A	B	D	E
E	9	30.81	24.99	16.33	11.08
A	15	39.20	33.30	24.70	19.39
B	25	53.05	47.04	38.40	33.24
C	37	69.40	63.50	54.80	49.86

REVISIONS

SYM	ECN	DESCRIPTION	DATE	APPROVED
1	HK--	First Release Drawing	01/17/08	IP
2	HK--	Dimension change	01/21/13	IP
3	HK--	Change pin length from to 3.5 to 3.4	12/13/18	IP
4	HK--	Added details for B/L	10/15/20	IP

D-SUB TECHNICAL DATA

SHELL : Steel 100u" min tin over 50u" min nickel over 50u" min copper
 BODY : PBT UL 94V-0, Color Black
 CONTACTS : Brass
 Gold flash over 50" min nickel on contact area
 100u" min tin over 50" min nickel on solder area
 BOARDLOCK: Brass. Tin plated
 SCREWLOCK : Brass. Nickel plated
 ELECTRICAL : Voltage rating 250 V Rms
 Current rating 3A
 Withstanding Voltage >1000 V Rms
 Insulation resistance >1000 M Ohms
 Contact resistance 20 mOhms max.
 MARKING : Amphenol...(Series No.)
 Commercial reference
 Manufacturing date

PRODUCT CODE

L 77 TS X H XX S OL2 RM8

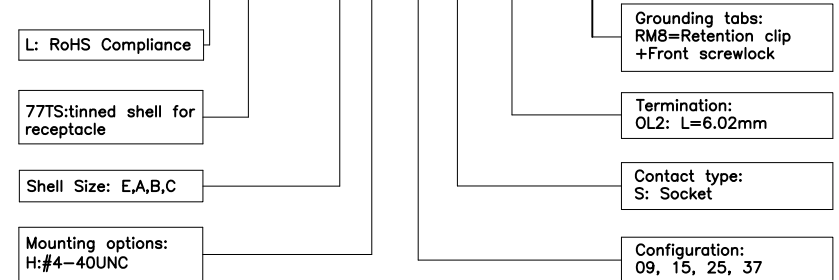

UNLESS OTHERWISE SPECIFIED TOLERANCES		APPROVAL		DATE
U.S.	METRIC	DRAWN	Jon. Lee	10/15/20
.X +/-	0.50	CHECKED	Tony Tang	10/15/20
.XX +/-	0.30	CHECKED		
.XXX +/-	0.20			
FRACTIONS +/-				
ANGLES +/-	5°			
FOR MATERIALS AND FINISHES SEE NOTES		DRAWING FILE :		
REMOVE SHARP EDGES		ANGLE OF PROJECTION		
DIMENSIONS				
U.S. INCHES				
METRIC MM				

Amphenol	
TITLE D-SUB connector	
SIZE	DRAWING NO.
A4	L77TSXHXXSOL2RM8
SCALE	NONE
SHEET	1 OF 1
REV.	4