

NOTES:

1. Circuit: ON/OFF
2. Operation force:  $500 \pm 200$ gf
3. Electrical rating: 8A 250VAC ULCUL CQC  
15A 125VAC ULCUL CQC  
12(6)A 250VAC ENEC
4. Contact resistance:  $< 50m\Omega$
5. Insulation resistance:  $> 100M\Omega$   
(500VDC between open contacts)
6. Dielectric strength:  $> 1500V$  1 minute
7. Color: cover is red, body is black.

电话 : 0769-82310511-867  
邮箱 : hooya89@hooya.hk  
V : hooya89

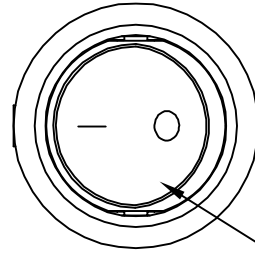

雾面红色上盖

Panel cut out(Thickness: 3mm Max)

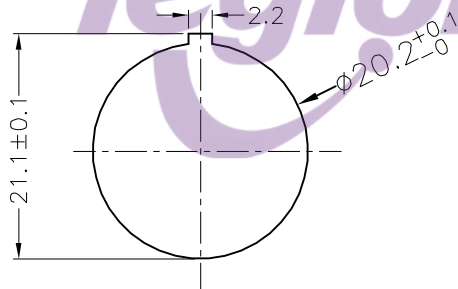

Circuit of Switch

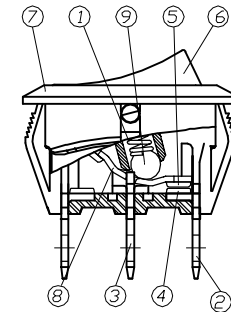
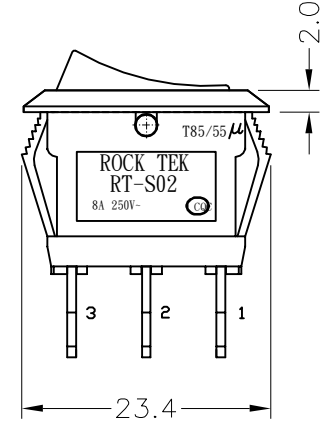
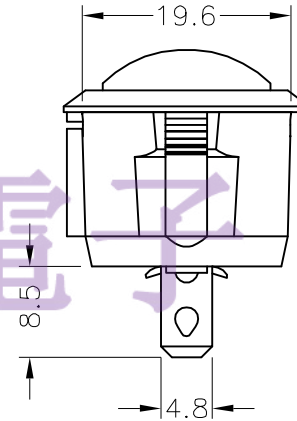
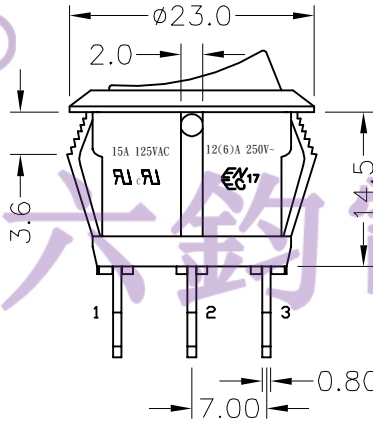
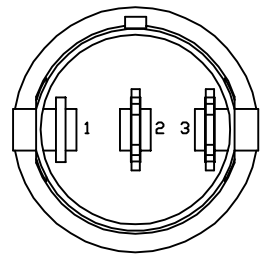
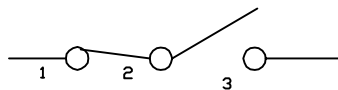

NO.	Name	Material	Q' ty
09	转轴	NICKEL PALTED BRASS	1pcs
08	接触片	C2680 1/2H Ag-plate	1pcs
07	本體	PA66	1pcs
06	上蓋	PA66	1pcs
05	動接點	Ag Clad Copper Alloy	2pcs
04	靜接點	Ag Clad Copper Alloy	2pcs
03	端子	C2680 1/2H Ag-plate	1pcs
02	端子	C2680 1/2H Ag-plate	2pcs
01	彈簧	SWC	1pcs

NO	DESCRIPTION	NO	DESCRIPTION	DIMENSIONAL TOLERANCES		APPROVED	CHECKED	DESIGN	DRAWN	ALL SIZE ARE IN		DRAWING NO.		
				RANGE	TOLERANCE					MM	FIT	*****	REV	
5	→	10	→											
4	→	9	→											
3	→	8	→	X	±0.4									
2	→	7	→	X.X	±0.3									
1	→	6	→	X.XX	±0.2									
				ANGLES	±0.5°									
LEGION ELECTRONIC & HARDWARE CO., LTD										RT-S02-127-R4NBR		*****		A

管林华  
17.11.13

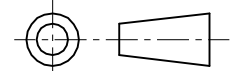

DRAWING NO. REV

\*\*\*\*\* A